

NOTICE: WHEN GOVERNMENT DRAWINGS, SPECIFICATIONS, OR OTHER DATA ARE USED IN CONNECTION WITH THIS DRAWING, THE UNITED STATES GOVERNMENT THEREBY ASSUMES NO LIABILITY FOR ANY ERRORS OR OMISSIONS, AND THE FACT THAT THE UNITED STATES GOVERNMENT HAS ACCEPTED THIS DRAWING FOR ANY PURPOSE DOES NOT CONSTITUTE AN ENDORSEMENT OR RECOMMENDATION OF THE QUALITY OF THE MATERIALS OR THE WORKMANSHIP THEREON. THE UNITED STATES GOVERNMENT WILL NOT BE RESPONSIBLE FOR ANY DAMAGE TO PERSONS OR PROPERTY, OR FOR ANY CONSEQUENCES ARISING FROM THE USE OF THIS DRAWING IN ANY MANNER.

THIS DRAWING HAS BEEN FORWARDED BY THE ENGINEERING DIVISION OF THE ARMY CORPS OF ENGINEERS AND IS NOT TO BE REPRODUCED OR COPIED IN ANY MANNER WITHOUT THE WRITTEN PERMISSION OF THE ENGINEERING DIVISION OF THE ARMY CORPS OF ENGINEERS.

*FOR INFORMATION ONLY. CONTRACTOR MAY AT HIS OPTION DEVIATE FROM THESE PROCESS DETAILS.

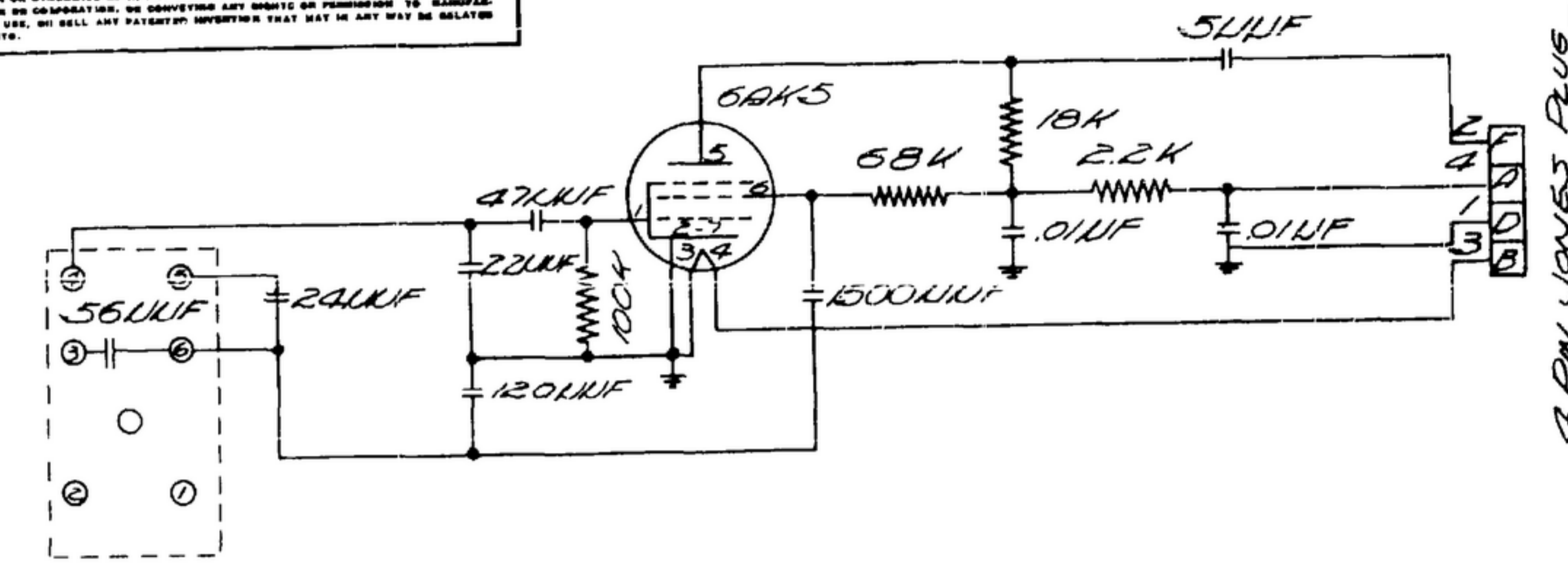

BOTTOM VIEW OF COIL

SCHEMATIC DIAGRAM

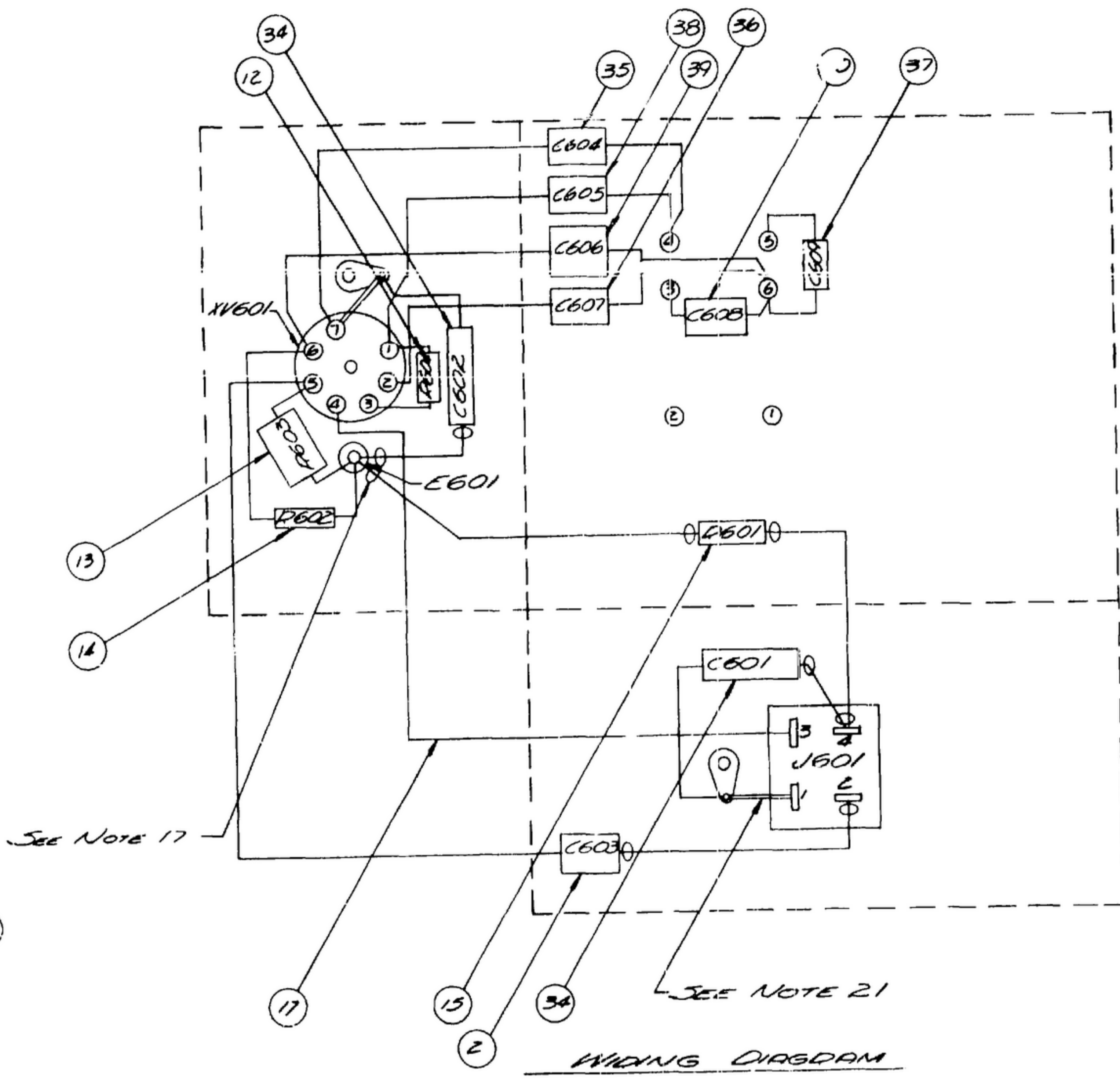

See Note 17

See Note 21

WIRING DIAGRAM

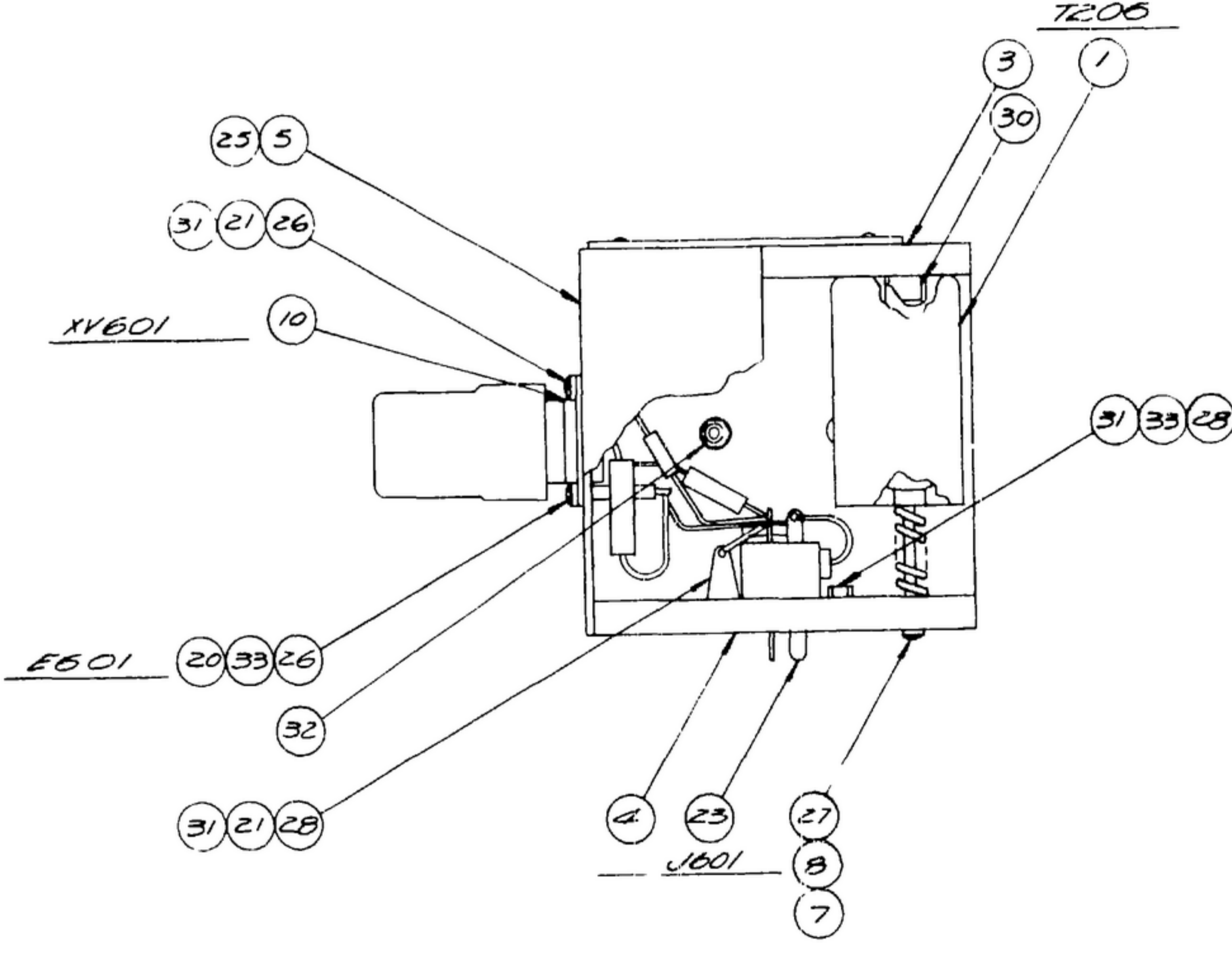

1V601

6E01

1V601

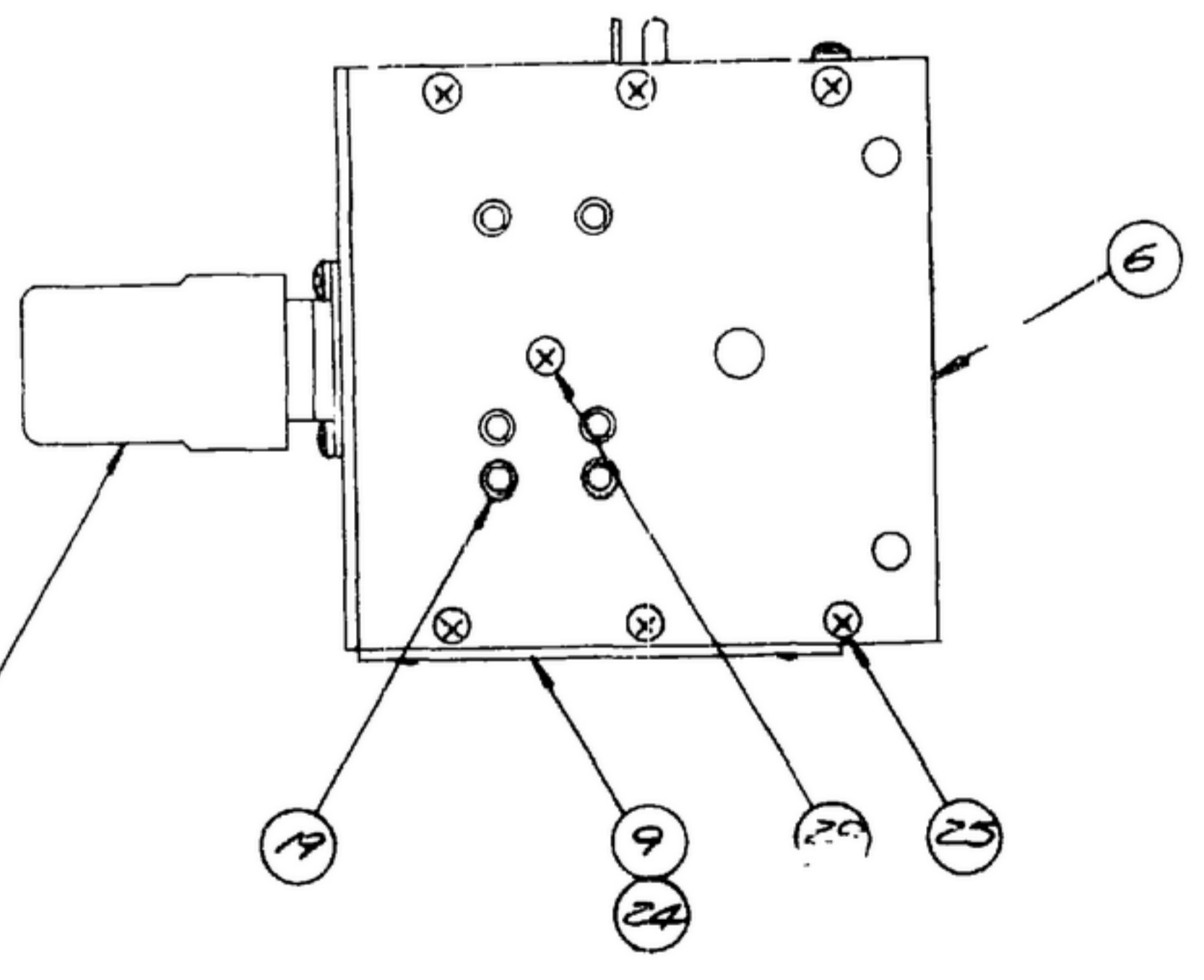

6E02

1V601

- NOTES
1. SUPPLIED BY GENERAL ELECTRIC CORP., SCHENECTADY, N.Y., OR EQUAL.
 2. SUPPLIED BY SELECTCO CORP., NEW ROCHELLE, N.Y., OR EQUAL.
 3. SUPPLIED BY WATSON INC., SCHILLER PARK, ILL., OR EQUAL.
 4. SUPPLIED BY DITTON-MAC GUYER CO., PROVIDENCE, R.I., OR EQUAL.
 5. SUPPLIED BY BENTLY HADDYS MFG CO., CONSHOHOCKEN, PA., OR EQUAL.
 6. SUPPLIED BY LEONARD B. JONES CO., CHICAGO, ILL., OR EQUAL.
 7. SUPPLIED BY LARKER AXION CORP., CLIFTON, N.J., OR EQUAL.
 8. SUPPLIED BY PNEOLL MFG CO., CHI, ILL., OR EQUAL. (PHILLIPS CROSS RECESSED)
 9. SUPPLIED BY BOSTON CO., WATERTOWN, CONN., OR EQUAL. (0.3DLINE)
 10. SUPPLIED BY CENTRAL SCREW CO., CHICAGO, ILL., OR EQUAL.
 11. SUPPLIED BY MILANO AUTOMATIC INC., OMAHA, NEB., OR EQUAL. (INSERT CAPTIVE)
 12. SUPPLIED BY SHAW-WOOD INC., CHICAGO, ILL., OR EQUAL.
 13. SUPPLIED BY SPARGUE ELECTRIC CO., NORTH ADAMS, MASS., OR EQUAL.
 14. SUPPLIED BY CORNELL-DUBILIER ELECTRIC CORP., SOUTH PLAINFIELD, N.J., OR EQUAL.
 15. SHALL BE TYPE 5 #22 SOFT ANNEALED TIN COATED.
 16. SHALL BE TYPE SPD-35(7)2201 BIAL.
 17. SYMBOL INDICATES WIRING (12).
 18. COIL (1) IS SUPPLIED IN POSITION SHOWN, WHEN IN USE COIL IS PLUGGED IN SOCKETS (19) & HELD IN PLACE WITH SCREW (19).
 19. ALL SOLDER SHALL BE JMS50 PER QQ-S-571.
 20. COAT ALL SOLDER CONNECTIONS WITH VARNISH TYPE 1 PER MIL-V-173.
 21. WIRE (15) IS SHOWN BY A DOUBLE LINE.
 22. ALL THREADS SHALL BE PER HANDBOOK HEB.

40	1	28	#22R5056		
39	1	28	#105D15		
38	1	28	#22R5047		
37	1	28	#22R5024		
36	1	28	#22R512		
35	1	28	#22R5022 MICA		14
34	1	19	CAPACITOR #67102394 PAIRED		13
33	2	18	WASHED & INT. SURE		12
32	1	17	4-40NC-EB K250 1/8 HEX		11
31	3	16	8-308C-EB T788 NUT 1/2 HEX		10
30	1	15	8-308C-EB T788 DRILL 1/8 DIA		9
29	1	14	8-308C-EB T788 FLAT HEAD		
28	2	13	8-308C-EB K178 FLAT HEAD		
27	1	12	8-308C-EB K178 FLAT HEAD		
26	2	11	8-308C-EB K178 FLAT HEAD		
25	10	10	8-308C-EB K178 FLAT HEAD		8
24	2	9	DAVE SCREW	STEEL	7
23	1	8	CONNECTOR P30428-M		6
22	23	7	TUBING #48000 1/8" B		5
21	2	6	LUG #3002		4
20	1	5	POST #103A-1		3
19	6	4	SOCKET #34T-1	TEFLON	2
18	1	3	TUBE #6AK5		1
17	1	2	JAN-C-75		16
16	23	1	SM-D-33307H WIDE MIL-H-3861 COATED		15
15	1	1	RC32G722J		
14	1	1	RC208F683K		
13	1	1	RC208F183K		
12	1	1	RC208F104K RESISTOR MIL-D-11		
11	1	1	75102 U01 SHIELD		
10	1	1	75102 D01 SOCKET JAN-528		
9	1	1	SM-C31958-4 UNMEDIATE		
8	1	1	SM-B-31957 SPRING		
7	1	1	SM-B-31956 NUT		
6	1	1	SM-B-31251 PLATE		
5	1	1	SM-B-31250 TOP		
4	1	1	SM-B-31249 PLATE		
3	1	1	SM-B-31248 PLATE		
2	1	1	SM-C-283281 CAPACITOR MICA		
1	1	1	SM-D-33307 COIL R55Y		

UNLESS OTHERWISE SPECIFIED DIMENSIONS ARE IN INCHES TOLERANCES ON FRACTIONS DECIMALS ANGLES		COLLINS RADIO CO CEDAR RAPIDS, IA 08719-PH-55-93		TEST OSC R-390AURR		DEPARTMENT OF THE ARMY SERIAL CORPS ENGINEERING LABORATORIES	
REVIEWED	XXX	DESIGNED	XXX	ANT. COIL T204 4.0-8.0 MC SIG C INSP 57292		NEW JERSEY	
APPROVED	XJL	DATE	5 SEPT 56	SM-D-33307			
NEXT ARMY	USED ON	APPLICATION		SCALE			