

R-391 506 18 65 00

NOTICE: When Government drawings, specifications, or other data are used for any purpose other than in connection with a definitely related Government procurement operation, the United States Government hereby incurs no responsibility or obligation whatsoever and the fact that the Government may have furnished, furnished, or in any way supplied the said drawings, specifications, or other data is not to be regarded by implication or otherwise as in any manner favoring the holder or any other person or corporation, or conveying any rights or permission to manufacture, use or sell any patented invention that may in any way be related thereto.

NOTE:
*FOR INFORMATION ONLY,
CONTRACTOR MAY AT HIS
OPTION DEVIATE FROM
THESE PROCESS DETAILS

NEXT ASSEMBLY	USED ON	SWE	REVISIONS	DATE	APPROVAL
SM-C-178869	SC-DL-178967	APPROVAL			
SM-C-178869	SC-DL-248775	SY	A ₃	6 OCT. 59	42428-PC-59-A1-51 REV'D. PME
SM-C-343590		PR			
		Y			
		M			
		CA	B ₁	15 OCT. 60	42428-PC-59 REV'D. PME
		CA	C	24 OCT. 60	42428-PC-59 REV'D. PME

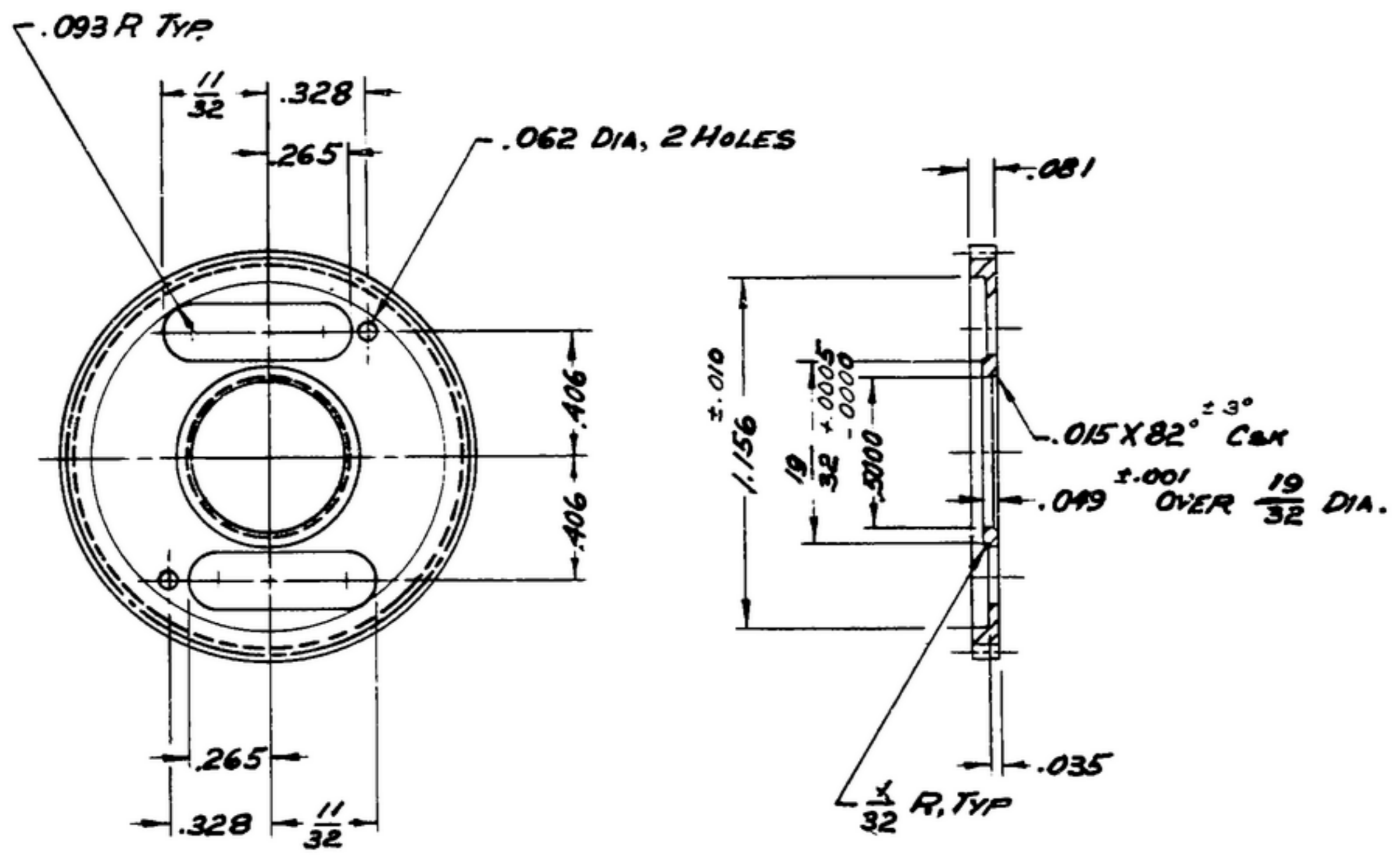

- (A₁)
NOTES: (C₁)
- BRASS, COMPOSITION 1, HARD, PER SPEC. QQ-B-613 (A₃)
 - NORMAL DIAMETRAL PITCH: 48
THEORETICAL PITCH DIAMETER: 1.3125
PRESSURE ANGLE: 14 1/2°
NUMBER OF TEETH: 63
BACKLASH ON NORMAL PITCH CIRCLE WHEN MATED WITH MASTER .0015-.0025.
AMERICAN STANDARD TOOTH FORM.
 - ECCENTRICITY BETWEEN BORE DIAMETER AND PITCH DIAMETER SHALL NOT EXCEED .002 TIR.
 - REMOVE ALL BURRS AND SHARP EDGES.
 - FINISH: CHEMICAL POLISH PER IRIDITE #7 METCOTE PROCESS BU,
ALLIED RESEARCH PRODUCTS INC., BALTIMORE, MD., OR EQUAL.
- (B₁)

UNLESS OTHERWISE SPECIFIED	AUTHENTICATION	SCALE	DATE
DIMENSIONS ARE IN INCHES	DRAWN 21852-PH	2/1	30 JUNE 53
TOLERANCES ON	TRACED PHOTO		
FRACTIONS ± 1/64	CHECKED [Signature]		
DECIMALS ± .005	VERIFIED P.D.B.R.		
ANGLES ±	APPROVED P.D.B.R.		
COMMERCIAL TOLERANCES APPLY TO STOCK SIZES	REVIEWED PME		
ALL SURFACES ✓	DATE 30 JUNE 53		

GEAR

DEPARTMENT OF THE ARMY
SIGNAL CORPS ENGINEERING LABORATORIES
FORT MONMOUTH NEW JERSEY

SM-C-178870