

EQUIP. TYPE *R390A/URR* EXP. NO.

*Col. 393-0205-0212-00*

NOTICE: WHEN GOVERNMENT DRAWINGS, SPECIFICATIONS, OR OTHER DATA ARE USED FOR ANY PURPOSE OTHER THAN IN CONNECTION WITH A DEFINITELY RELATED GOVERNMENT PROCUREMENT OPERATION, THE UNITED STATES GOVERNMENT THEREBY INCURS NO RESPONSIBILITY FOR ANY OBLIGATION WHATSOEVER; AND THE FACT THAT THE GOVERNMENT MAY HAVE FORMULATED, FURNISHED, OR IN ANY WAY SUPPLIED THE SAID DRAWINGS, SPECIFICATIONS, OR OTHER DATA IS NOT TO BE REGARDED BY IMPLICATION OR OTHERWISE AS IN ANY MANNER LICENSING THE HOLDER OR ANY OTHER PERSON OR CORPORATION, OR CONVEYING ANY RIGHTS OR PERMISSIONS TO MANUFACTURE, USE, OR SELL ANY PATENTED INVENTION THAT MAY IN ANY WAY BE RELATED THERETO.

THIS DOCUMENT HAS BEEN PURCHASED BY THE GOVERNMENT AND MAY BE REPRODUCED AND USED IN CONNECTION WITH ANY GOVERNMENT PROCUREMENT OR MAINTENANCE OPERATION.

\* FOR INFORMATION ONLY. CONTRACTOR MAY AT HIS OPTION DEVIATE FROM THESE PROCESS DETAILS.

~~X SWE APPROVAL~~  
~~SYM PR10042-5~~

REVISIONS			
SYM	DESCRIPTION	DATE	APPROVAL
A <sub>2</sub>	A <sub>1</sub> ADDED APPL. SM-D-343612 SM-C-343634 & SM-C-343633 A <sub>2</sub> ADDED ALUMINUM	9 OCT 59	42428-PC 59-AI-SI REV'D PME

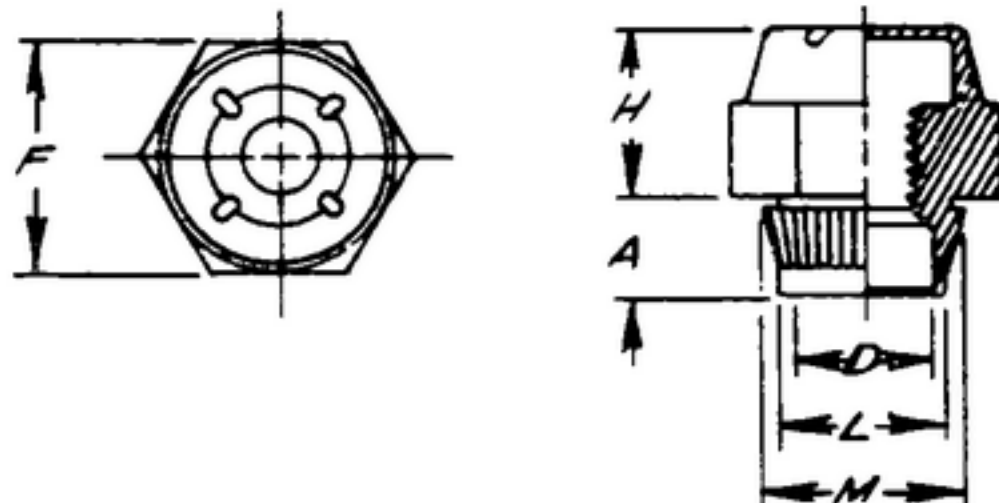

COLLINS PART NO.	DASH NUMBER	MFGR'S PART NO.	LENGTH OF SHANK "A" ±.006	FOR MAT'L THICKNESS		RECOMMENDED HOLE SIZE		H		F		M		L		D		THREAD SIZE
				MIN.	MAX.	MIN.	MAX.	MIN.	MAX.	MIN.	MAX.	MIN.	MAX.	MIN.	MAX.	MIN.	MAX.	
<del>5590251002</del>	<del>SM-B-283164-1</del>	<del>68NC3-62</del>	<del>.105</del>	<del>.054</del>	<del>.073</del>	<del>.217</del>	<del>.219</del>	<del>.173</del>	<del>.203</del>	<del>.303</del>	<del>.323</del>	<del>.220</del>	<del>.224</del>	<del>.213</del>	<del>.216</del>	<del>.163</del>	<del>.168</del>	<del>6-32NC-3B</del>
<del>5590252002</del>	<del>2</del>	<del>68NC4-82</del>	<del>.135</del>	<del>.074</del>	<del>.103</del>	<del>.268</del>	<del>.271</del>	<del>.235</del>	<del>.265</del>	<del>.365</del>	<del>.385</del>	<del>.273</del>	<del>.277</del>	<del>.264</del>	<del>.267</del>	<del>.218</del>	<del>.223</del>	<del>8-32NC-3B</del>

NOTES:

1. PART MAY BE SUPPLIED BY ELASTIC STOP NUT CORP., UNION, NEW JERSEY OR EQUAL, PROVIDING IT MEETS THE FOLLOWING REQUIREMENTS AND DIMENSIONS SHOWN.

DESCRIPTION: ELASTIC STOP-CLINCH NUT, WITH NYLON SELF LOCKING INSERT.

A<sub>2</sub>

MATERIAL: DURAL ALUMINUM

FINISH: E 511 PER SPEC MIL-F-14078

A<sub>1</sub>

COLLINS PART NO.	ITEM	QTY	PART NO.	DESCRIPTION	DATE	DATE SPEC
LIST OF MATERIAL						
COLLINS PART NO. <del>559-0251-002</del> <del>559-0252-002</del>						

SM-C-343633	DRAWN	CHECKED	APPROVED	COLLINS RADIO CO. CEDAR RAPIDS, IOWA	NUT - STOP	DEPARTMENT OF THE ARMY SIGNAL CORPS ENGINEERING LABORATORIES FORT MONMOUTH NEW JERSEY
SM-C-343634	<i>R. E. E.</i>	<i>[Signature]</i>		14214-PH-51-93		
SM-D-343612	UNLESS OTHERWISE SPECIFIED: DECIMAL DIMENSIONS INCLUDING HOLE SIZES MAY VARY ±.005 FRACTIONAL DIMENSIONS INCLUDING HOLE SIZES MAY VARY ±1/64 MACHINED ANGLES MAY VARY ±1° SHEARED ANGLES MAY VARY ±.25° BROKEN ANGLES MAY VARY ±1° ECCENTRICITY BETWEEN ANY DIAMETERS ON THE SAME CENTERLINE SHALL NOT EXCEED .010 TOTAL INDICATOR READING. ALL DIMENSIONS ARE FINISH DIMENSIONS INCLUDING APPLIED FINISH AND ARE GIVEN IN INCHES.			SIGNAL CORPS		
<del>5580478003</del>	<del>4</del>	<del>SM-C-249126</del>		REVIEWED PME		
<del>5580479003</del>	<del>4</del>	<del>SM-C-249127</del>		APPROVED HLY PME		
<del>5580381004</del>	<del>5</del>	<del>SM-D-248982</del>	<del>SC-DL-248775</del>	DATE 18 JAN 56	SCALE	
COLLINS NO.	QTY	NEXT ASSY	USED ON			

APPLICATION:

SM-B-283164