

NOTICE: WHEN GOVERNMENT DRAWINGS, SPECIFICATIONS, OR OTHER DATA ARE USED FOR ANY PURPOSE OTHER THAN IN CONNECTION WITH A DEFINITELY RELATED GOVERNMENT PROCUREMENT OPERATION, THE UNITED STATES GOVERNMENT THEREBY INCURS NO RESPONSIBILITY FOR ANY OBLIGATION WHATSOEVER AND THE FACT THAT THE GOVERNMENT MAY HAVE FORMULATED, FURNISHED, OR IN ANY WAY SUPPLIED THE SAID DRAWINGS, SPECIFICATIONS, OR OTHER DATA IS NOT TO BE REGARDED BY REPLICATION OR OTHERWISE AS IN ANY MANNER LICENSING THE HOLDER OR ANY OTHER PERSON OR CORPORATION, OR CONVEYING ANY RIGHTS OR PERMISSION TO MANUFACTURE, USE, OR SELL ANY PATENTED INVENTION THAT MAY IN ANY WAY BE RELATED THERETO.

THIS DOCUMENT HAS BEEN PURCHASED BY THE GOVERNMENT AND MAY BE REPRODUCED AND USED IN CONNECTION WITH ANY GOVERNMENT PROCUREMENT OR MAINTENANCE OPERATION.

\* FOR INFORMATION ONLY. CONTRACTOR MAY AT HIS OPTION DEVIATE FROM THESE PROCESS DETAILS.

REVISIONS			
SYM	DESCRIPTION	DATE	APPROVAL
<del>SYM PR10042-9</del>	<del></del>		
A <sub>2</sub>	A <sub>1</sub> -WAS 245 A <sub>2</sub> -ADDED APPL SM-D-343620	4 NOV 59	43428-PC-59 A1-51 REV'D PME

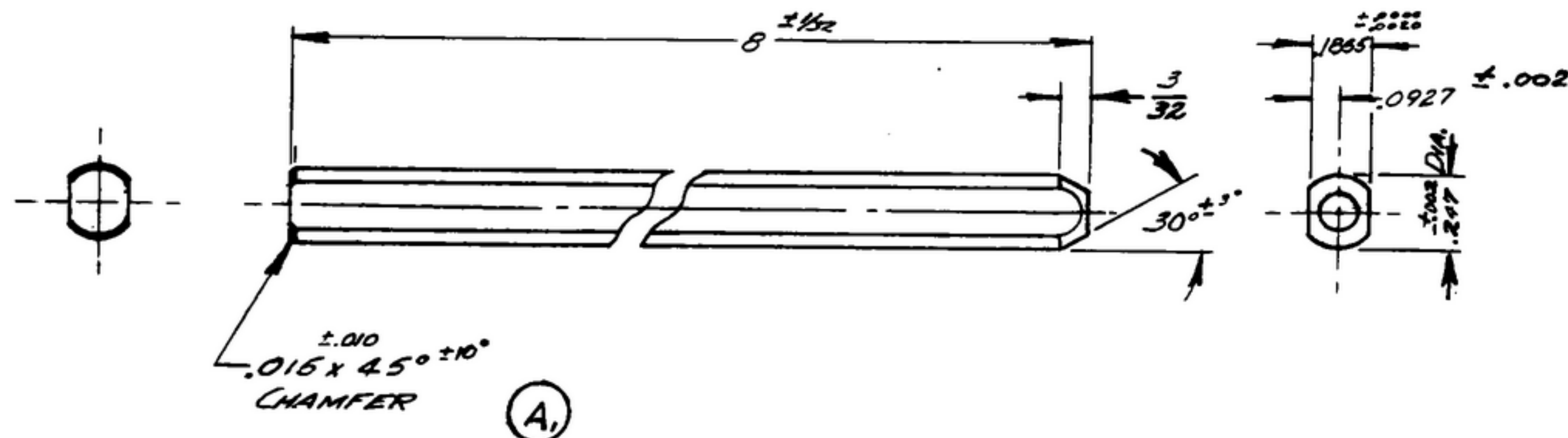

ALUMINUM ALLOY 2024 TEMPER T4, PER SPEC. QQ-A-267

FINISH: E513 PER SPEC MIL-F-14072  
\* ~~COLLINS 580-0036-00~~

NOTES:  
1. SHAFT TO BE STRAIGHT WITHIN .020 T.I.R.

COLLINS PART NO.	ITEM	REQD	PART NO.	DESCRIPTION	DATE	DATE SPEC
LIST OF MATERIAL						
COLLINS PART NO. 558-0357-002						

COLLINS NO.	QTY	NEXT ASSY	USED ON
558-0363-004	1	SM-D-248818	SM-D-248715
		SM-D-343620	

DRAWN HENRY  
CHECKED *lh*  
APPROVED

UNLESS OTHERWISE SPECIFIED:  
DECIMAL DIMENSIONS INCLUDING HOLE SIZES MAY VARY ±.008  
FRACTIONAL DIMENSIONS INCLUDING HOLE SIZES MAY VARY ±1/64  
MACHINED ANGLES MAY VARY ±.1°  
SHEARED ANGLES MAY VARY ±.25°  
BROKEN ANGLES MAY VARY ±1°  
ECCENTRICITY BETWEEN ANY DIAMETERS ON THE SAME CENTERLINE SHALL NOT EXCEED .010 TOTAL INDICATOR READING.  
ALL DIMENSIONS ARE FINISH DIMENSIONS INCLUDING APPLIED FINISH AND ARE GIVEN IN INCHES.

COLLINS-RADIO-CO.  
CEDAR-RAPIDS, IOWA  
14214-P.H.  
51-93

SIGNAL CORPS  
REVIEWED PME  
APPROVED HLY  
PME

DATE 16 Dec 58 SCALE 2/1

SHAFT-SWITCH

DEPARTMENT OF THE ARMY  
SIGNAL CORPS ENGINEERING  
LABORATORIES  
FORT MONMOUTH NEW JERSEY  
SM-B-249008