

NOTICE: WHEN GOVERNMENT DRAWINGS, SPECIFICATIONS, OR OTHER DATA ARE USED FOR ANY PURPOSE OTHER THAN IN CONNECTION WITH A DEFINITELY RELATED GOVERNMENT PROCUREMENT OPERATION, THE UNITED STATES GOVERNMENT THEREBY INCURS NO RESPONSIBILITY FOR ANY OBLIGATION WHATSOEVER; AND THE FACT THAT THE GOVERNMENT MAY HAVE FORMULATED, FURNISHED, OR IN ANY WAY SUPPLIED THE SAID DRAWINGS, SPECIFICATIONS, OR OTHER DATA IS NOT TO BE REGARDED BY IMPLICATION OR OTHERWISE AS IN ANY MANNER LICENSING THE HOLDER OR ANY OTHER PERSON OR CORPORATION, OR CONVEYING ANY RIGHTS OR PERMISSION TO MANUFACTURE, USE, OR SELL ANY PATENTED INVENTION THAT MAY IN ANY WAY BE RELATED THERETO.

NOTE: *FOR INFORMATION ONLY, CONTRACTOR MAY AT HIS OPTION DEVIATE FROM THESE PROCESS DETAILS

* SWE. APPROVAL		REVISIONS			
SYM	PR	SYM	DESCRIPTION	DATE	APPROVAL
	PR10042-4	A4	A ₁ - REMOVED .150 & 2 13/16 DIM. A ₂ - REVISED PICTORIAL; A ₃ - ADDED APPL. SM-B-178864, SC-DL-248775; A ₄ - REVISED NOTES.	8 OCT. 59	42428-PC-59-A1-51 REV'D.
	CA 84835	B1	(1) - ADDED NOTE *6.	13 OCT. 60	42428-PC-59 REV'D. PME

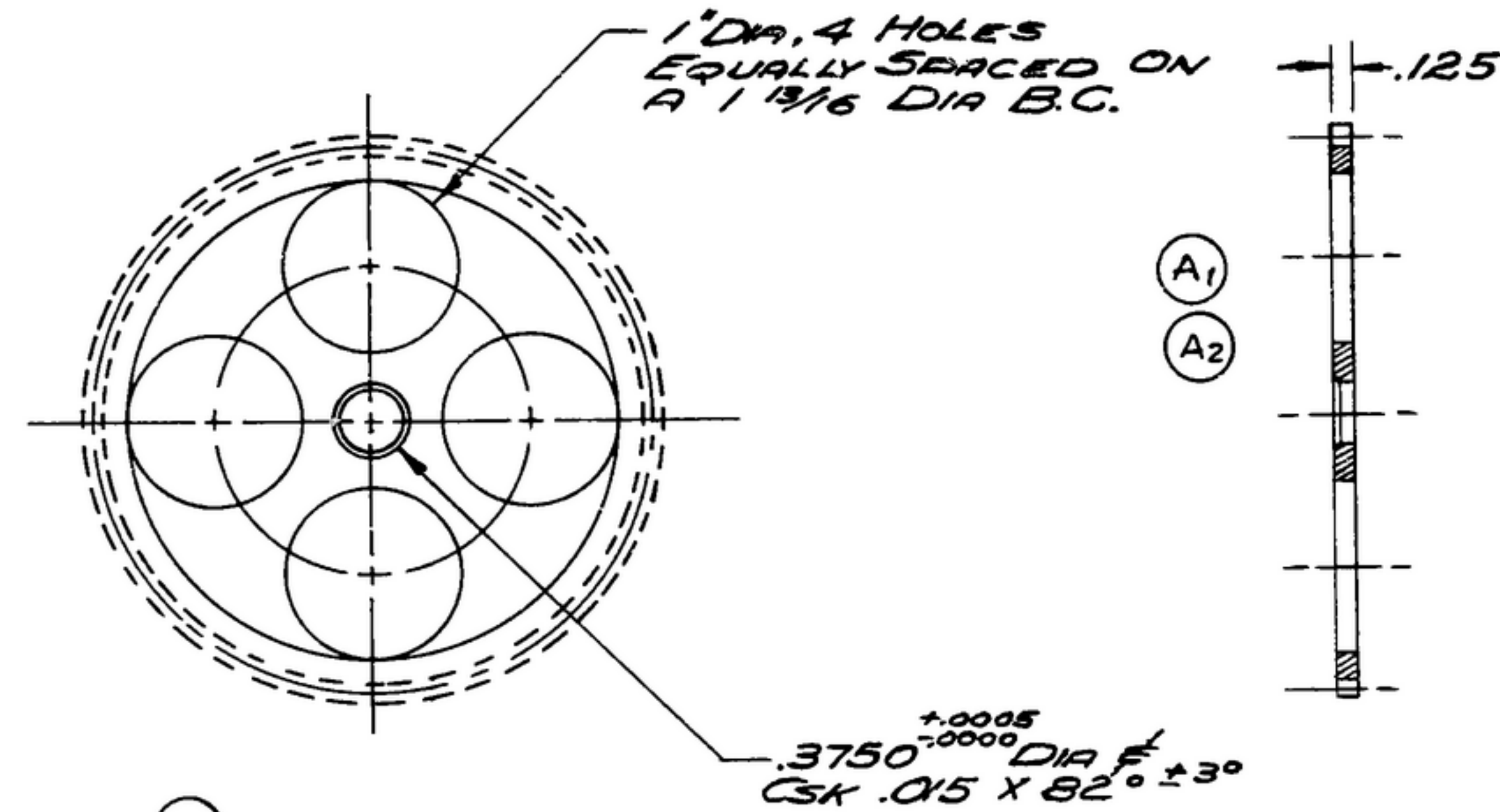

NOTES: (A₄)

- BRASS, COMP 1, TEMPER H, PER SPEC QQ-B-626.
- GEAR DATA
 NORMAL DIAMETRICAL PITCH: 32
 THEORETICAL PITCH DIA. 3.1875
 PRESSURE ANGLE: 20°
 NO. OF TEETH 102
 BACKLASH ON NORMAL PITCH CIRCLE
 WHEN MATED WITH MASTER .001-.002
 AMERICAN STANDARD INVOLUTE TOOTH FORM
- ECCENTRICITY BETWEEN PITCH DIA. & BORE NOT TO EXCEED .0012
- AXIAL RUNOUT NOT TO EXCEED .010 T.I.R. AT 1.500 RADIUS.
- REMOVE ALL BURRS & SHARP EDGES.
- FINISH: CHEMICAL POLISH (A₃)
 IRIDITE #7 METCOTE
 PROCESS BU, ALLIED RESEARCH PRODUCTS INC. BALTIMORE, MD., OR EQUAL.

REQD	PART NO.	DESCRIPTION	MATL	MATL SPEC
LIST OF MATERIAL				
GEAR				
AUTHENTICATION				
DRAWN 21852-PH -50-93				
TRACED PHOTO				
CHECKED <i>[Signature]</i>				
VERIFIED P. D. BR.				
APPROVED P. D. BR.				
REVIEWED P. M. E.				
DATE 3 JULY 53 SCALE 1/1				
SIGNAL CORPS ENGINEERING LABORATORIES FORT MONMOUTH NEW JERSEY				SM-B-178865