

NOTICE: When Government drawings, specifications, or other data are used for any purpose other than in connection with a definitely related Government procurement operation, the United States Government thereby incurs no responsibility or any obligation whatsoever; and the fact that the Government may have furnished, or in any way supplied the said drawings, specifications, or other data is not to be regarded by implication or otherwise as in any manner licensing the holder or any other person or corporation, or conveying any rights or permission to manufacture, use or sell any patented invention that may in any way be related thereto.

NEXT ASSEMBLY	USED ON	SNE APPROVAL	REVISIONS		DATE	APPROVAL
			SYM	DESCRIPTION		
SM-B-17885B	SC-DL-178467	SNE APPROVAL 5/14/53 M. CA 8458	A ₃	A ₁ - WAS COMP. FM, AN-5-771; A ₂ - ADDED FIN. NOTE; A ₃ - ADDED APPL. SM-B-17885B, SC-DL-248775	6 OCT 59	42428-PC-59-A1-51 REVD.
SM-B-17885B	SC-DL-248775		B	STL. COMP. 3035 WAS 3035	24 DEC 59	42428-PC-59-A1-51 REF. PME
SC-DL-144500			C,	C, ADDED: "SURFACE CONDITION e"	25 SEP 64	15283-PP-63 REVD EC-2

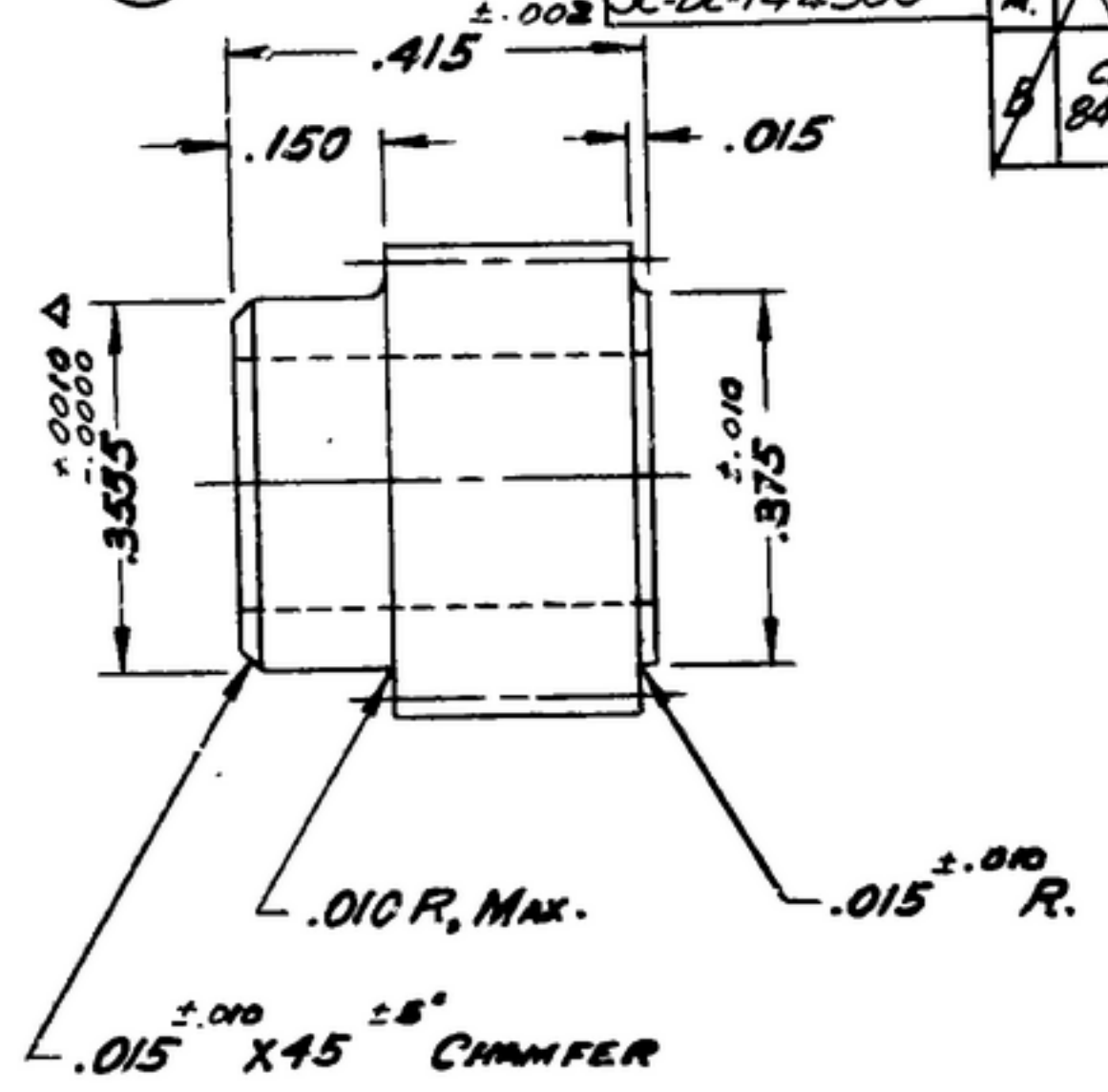
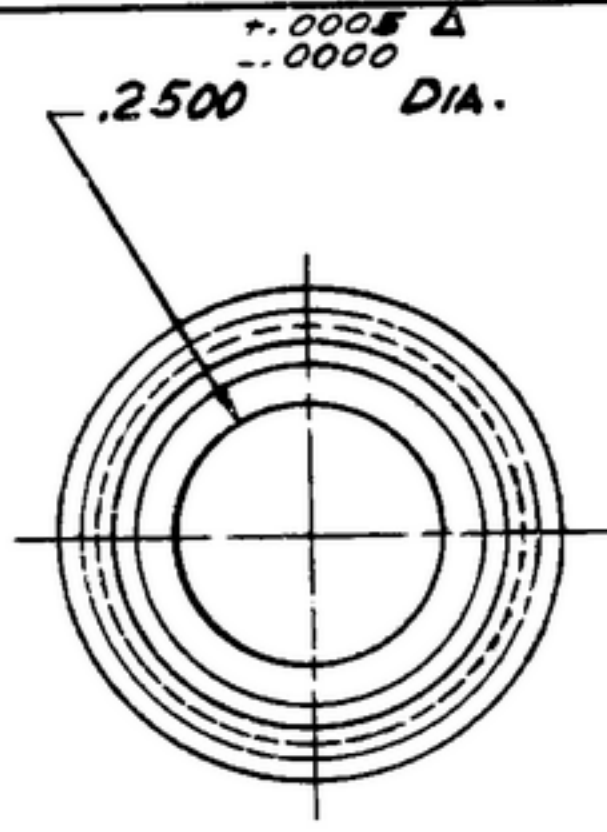

(A₁) STEEL, COMPOSITION 3035, CONDITION B, SURFACE CONDITION e, PER SPEC MIL-5-7720 (C₁)

1. NORMAL DIAMETRAL PITCH: 48
THEORETICAL PITCH DIAMETER: .4375
PRESSURE ANGLE: 14 1/2°
NUMBER OF TEETH: 21
BACKLASH ON NORMAL PITCH CIRCLE WHEN MATED WITH MASTER: .0015-.0025 TIR.
2. ECCENTRICITY BETWEEN DIAMETERS MARKED Δ ON SAME CENTERLINE SHALL NOT EXCEED .005 TIR.
3. ECCENTRICITY BETWEEN BORE DIAMETER AND PITCH DIAMETER SHALL NOT EXCEED .002 TIR.
4. PART MUST BE FREE OF BURRS & SHARP EDGES.
- (A₂) 5. FINISH E-300, PER SPEC. MIL-F-14072.

NOTE: *FOR INFORMATION ONLY, CONTRACTOR MAY AT HIS OPTION DEVIATE FROM THESE PROCESS DETAILS.

ISS.	PART NO.	DESCRIPTION	MATERIAL	QTY	NOTE
		GEAR			
UNLESS OTHERWISE SPECIFIED		AUTHENTICATION DRAWN 21852-PH 50-93 TRACED PHOTO CHECKED [Signature] VERIFIED P.D.B.R. APPROVED P.D.B.R. REVIEWED PME DATE 1-JULY-53			
DIMENSIONS ARE IN INCHES TOLERANCES ON FRACTIONS ± — DECIMALS ± .005 ANGLES ± — COMMERCIAL TOLERANCES APPLY TO STOCK SIZES ALL SURFACES ✓		DEPARTMENT OF THE ARMY SIGNAL CORPS ENGINEERING LABORATORIES FORT MONMOUTH NEW JERSEY SM-B-178859			
		SCALE 4/1			