

R391 506-1848-002

NOTICE: WHEN GOVERNMENT DRAWINGS, SPECIFICATIONS, OR OTHER DATA ARE USED FOR ANY PURPOSE OTHER THAN IN CONNECTION WITH A DEFINITELY RELATED GOVERNMENT PROCUREMENT OPERATION, THE UNITED STATES GOVERNMENT THEREBY INCURS NO RESPONSIBILITY FOR ANY SOLIDATION WHATSOEVER; AND THE FACT THAT THE GOVERNMENT MAY HAVE FORMULATED, PUBLISHED, OR IN ANY WAY SUPPLIED THE SAID DRAWINGS, SPECIFICATIONS, OR OTHER DATA IS NOT TO BE REGARDED BY IMPLICATION OR OTHERWISE AS IN ANY MANNER LICENSING THE HOLDER OR ANY OTHER PERSON OR CORPORATION, OR CONVEYING ANY RIGHTS OR PERMISSION TO MANUFACTURE, USE, OR SELL ANY PATENTED INVENTION THAT MAY IN ANY WAY BE RELATED THERETO.

~~X SWE APPROVAL~~
~~SYM PR-10042-4~~

REVISIONS			
SYM	DESCRIPTION	DATE	APPROVAL
A ₂	A ₁ -QQ-B-74G; A ₂ -ADDED APPL SM-C-248967, SC-DL-248775	8 OCT 55	42428-PC-59 MPS REID

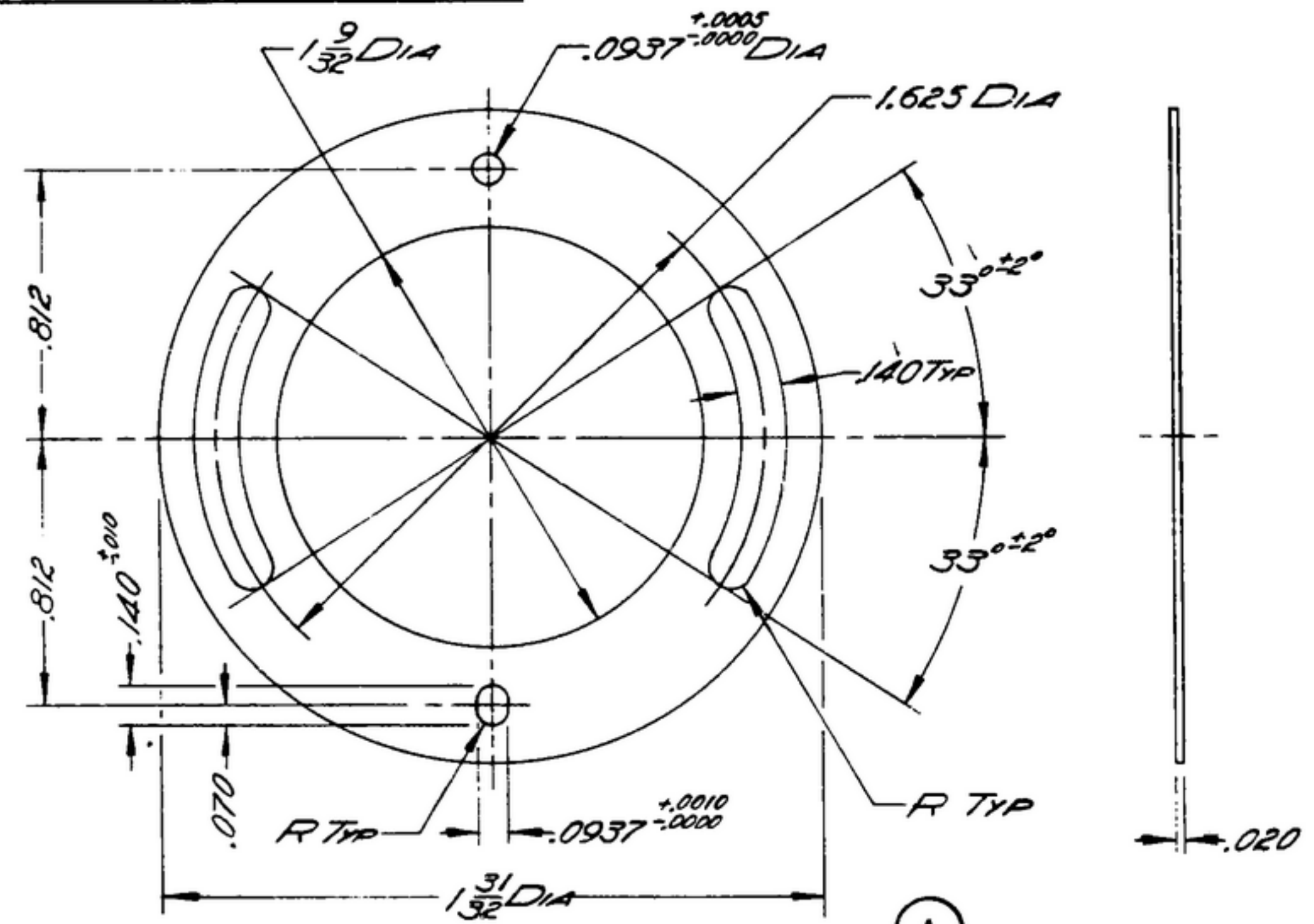

PHOSPHOR BRONZE COMP A, 1/2 H PER SPEC QQ-P-330.
 1-REMOVE ALL BURRS AND SHARP EDGES.
 2-PART MUST BE FLAT WITHIN .005 TIR.

NOTE:
 *FOR INFORMATION ONLY,
 CONTRACTOR MAY AT HIS
 OPTION DEVIATE FROM
 THESE PROCESS DETAILS

REQD	PART NO.	DESCRIPTION	MATL	MATL SPEC
LIST OF MATERIAL				

		UNLESS OTHERWISE SPECIFIED		AUTHENTICATION		PLATE	SIGNAL CORPS ENGINEERING LABORATORIES FORT MONMOUTH NEW JERSEY
		DIMENSIONS ARE IN INCHES		DRAWN 21832-PH-50-93			
		TOLERANCES ON		TRACED PHOTO			
		FRACTIONS DECIMALS ANGLES		CHECKED <i>[Signature]</i>			
		±1/64 ±.005		VERIFIED <i>[Signature]</i>			
A ₂		SM-C-248967	SC-DL-248775	APPROVED <i>[Signature]</i>		SM-B-178769	
		SM-C-178764	SC-DL-178767	REVIEWED <i>[Signature]</i>			
APPLICATION		NEXT ASSY	USED ON	DATE 28 SEPT 55			
				SCALE 2/1			