

R-24-576 1910-103

NOTICE: When Government drawings, specifications, or other data are used for any purpose other than in connection with a definitely related Government procurement operation, the United States Government thereby incurs no responsibility or any obligation whatsoever, and the fact that the Government may have formulated, furnished, or in any way supported the said drawings, specifications, or other data is not to be regarded by implication or otherwise as in any manner favoring the holder or any other person or corporation, or conveying any rights or permission to manufacture, use or sell any patented invention that may in any way be related thereto.

NEXT ASSEMBLY	USED ON	SWE * APPROVAL	REVISIONS			
			SYM	DESCRIPTION	DATE	APPROVAL
SM-C-178733	SC-DL-178467	SWE * APPROVAL SY 10042-3	A ₂	A ₁ - WAS COMP. FM, AN-S-771; A ₂ - ADDED APPL. SM-C-248969, SC-DL-248775.	5 OCT. 59	42428-PC-59-AI-51 REV'D. P.M.E.
SM-C-248969	SC-DL-248775					

(A₂)

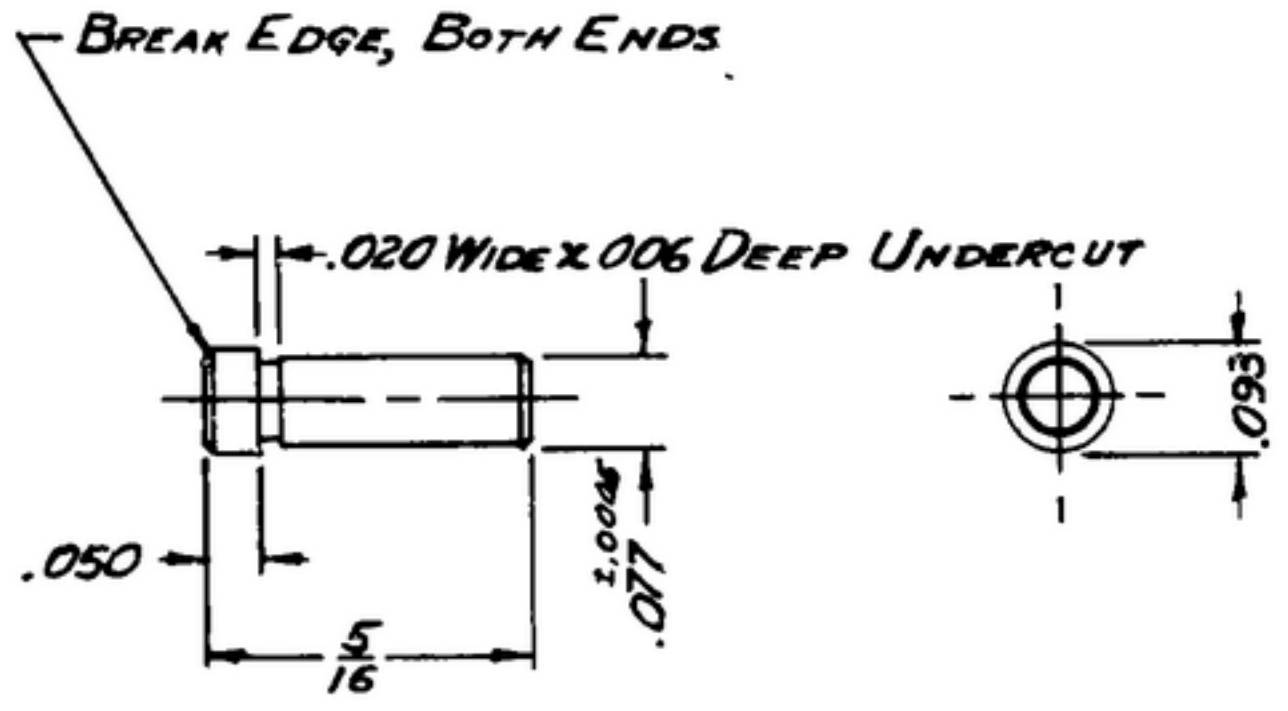

(A₁) STEEL, COMP. 303S COND. B, PER SPEC. MIL-S-7720.

NOTE:
FOR INFORMATION ONLY,
CONTRACTOR MAY AT HIS
OPTION DEVIATE FROM
THESE PROCESS DETAILS

UNLESS OTHERWISE SPECIFIED	AUTHENTICATION	DESCRIPTION	DATE	SPEC	NOTE
DIMENSIONS ARE IN INCHES TOLERANCES ON FRACTIONS ± 1/64 DECIMALS ± .005 ANGLES ± — COMMERCIAL TOLERANCES APPLY TO STOCK SIZES ALL SURFACES ✓	DRAWN <i>21852-PH-50-92</i> TRACED <i>PHOTO</i> CHECKED <i>PK</i> VERIFIED <i>POBR</i> APPROVED <i>POBR</i> REVIEWED <i>PME</i> DATE <i>24-JUN-53</i>	PIN			
			SCALE 4/1		DEPARTMENT OF THE ARMY SIGNAL CORPS ENGINEERING LABORATORIES FORT MONMOUTH NEW JERSEY SM-B-178736

WHEN REFERRING TO THIS DRAWING STATE DRAWING NO., APPLICABLE ISSUE SYMBOL AND DATE