

INSTRUCTIONS FOR INSTALLING THE
163183 MODIFICATION KIT TO PROVIDE
DC MAGNET OPERATED PRINT SUPPRESSION
ON A MODEL 28 TYPING UNIT (LP6, LP9
AND UP)

1. GENERAL

a. The 163183 Modification Kit when installed on a Model 28 Typing Unit (LP6, LP9 and up) equipped with the 157509 "On Line" Stunt Shift Control Modification Kit, provides for suppression of printing. This is accomplished as follows: When the magnet is energized, the armature is attracted and causes the armature extension to pivot into the path of the suppression arm. This limits the angular movement of the suppression arm and prevents operation of the type box clutch. The magnet operates from 48V DC, or with a 2000 ohm series resistor (not furnished) from 120V DC.

b. The 163183 Modification Kit consists of:

2	2191	Washer, Lock	*2	156740	Screw
1	7002	Washer, Flat	1	173882	Stud
*15	74891	Shim	1	163254	Magnet Assembly
2	151631	Screw			

*c. For part numbers referred to and for parts ordering information, see Teletype Model 28 Printer Parts Bulletin 1149B.

*2. INSTALLATION (Figure 1)

NOTE

After installation and adjustments make certain all nuts and screws are tight before placing unit in operation.

- a. Remove and discard the upper 151442 or 151659 Screw which secures the left vertical positioning lever. Retain the nut and lock washer.
- b. Install the 173882 Stud with the nut and lock washer in place of the screw previously removed in Paragraph 2a.
- c. Remove and discard the lower 151657 Screw that secures the left stunt box bracket in place.
- d. Install the 163254 Magnet Assembly using the two 151631 Screws,

* Indicates change.

d. Install the 163254 Magnet Assembly using the two 151631 Screws, 7002 Flat Washer and 2191 Lock Washers as shown in Figure 1.

3. ADJUSTMENTS

For standard adjustment procedure, refer to standardized adjustment information. Make the following adjustments:

- *a. Type Box Clutch Trip Arm except using .040 to .055 clearance.
- b. Type Box Suppression Arm.
- c. Blocking Bail.
- d. Magnet Bracket Position.

*With the 153570 suppression arm blocked by the blocking bail extension, hold the armature against the pole face of the magnet. The end of the armature extension shall be (1) .010 to .015 beyond the inner surface of the suppression arm at the center of the armature extension, and (2) there shall be no clearance between the uppermost portion of the blocking surface of the armature extension and the bottom surface of the suppression arm.

*To Adjust: Tighten the 151630 magnet bracket mounting screw friction tight, and using an eccentric adjusting tool, either pivot the magnet bracket or move it longitudinally on the mounting bracket so that the upper surface of the armature extension is pressed firmly against the bottom of the suppression arm at a point that will provide the proper amount of overlap. If the required amount of overlap can not be obtained it will be necessary to remove the two 151722 screws that mount the 153570 suppression arm to the 153569 type box clutch trip arm.

Reusing the two 7002 flat washers and 2191 lock washers remount the suppression arm using the two 156740 screws provided in the modification kit. Before tightening these screws insert enough 74891 shims, between the suppression arm and the type box clutch trip arm to provide the required overlap. Recheck the type box clutch suppression arm adjustment and blocking bail adjustment as listed in standard adjusting information.

*To Check: With the armature extension blocking the suppression arm rotate the blocking bail extension under the end of the suppression arm. It should slide under the arm with no perceptible clearance.

e. Armature

With the armature released there should be .012" to .030" clearance between the end of the armature extension and the outer surface of the suppression arm. To adjust, position the armature with the armature stop screw. Recheck Magnet Bracket Position adjustment 3. d. and refine as required.

*f. Armature Extension

There should be no interference between movement of the armature extension and the blocking bail extension. Refine the above adjustments as necessary to prevent interference.

*g. Armature Spring Tension

With the spring scale applied along the center line of the magnet, it should require 3/4 to 1-1/2 ounces to just start the armature moving away from the armature stop screw.

NOTE

The armature must pivot freely without binds or jams.

4. LUBRICATION

*a. Apply one drop of oil at each armature pivot point in accordance with standard practice. Do not allow any oil to collect on the magnet pole face.

*b. Apply thin film of grease to the blocking surface of the armature extension.

*

*

*

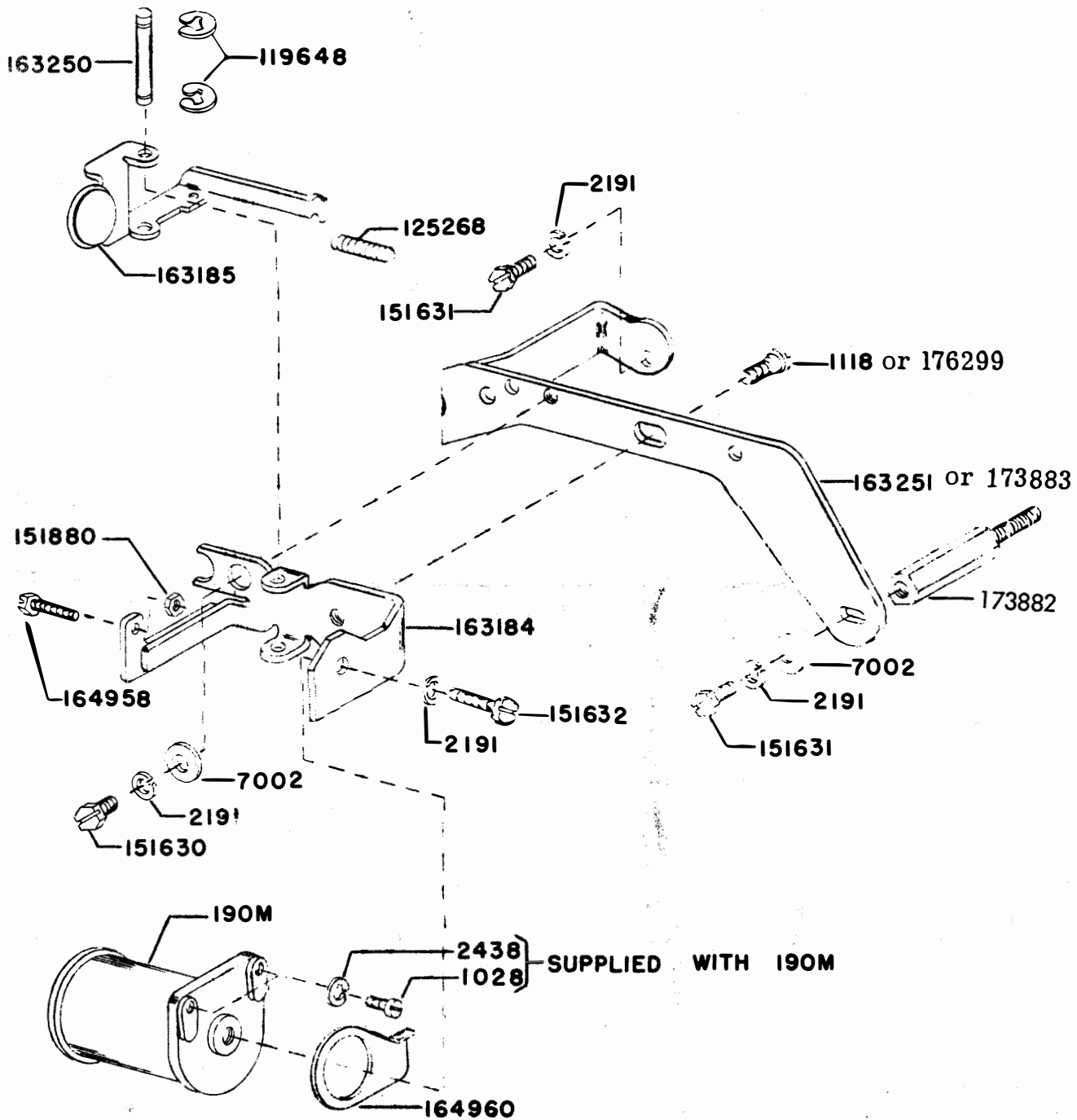

163183 MODIFICATION KIT TO EQUIP A TYPING UNIT WITH D.C.
MAGNET OPERATED PRINT SUPPRESSION

FIGURE 1