

INSTRUCTIONS FOR INSTALLING THE 176713 MODIFICATION KIT  
ON MODEL 28 CABINET (LAAC) AND THE 176714 MODIFICATION  
KIT ON MODEL 28 CABINET (LAC) TO PROVIDE A LOW-PAPER  
AND PAPER-OUT ALARM (SPROCKET FEED PAPER)

1. GENERAL

a. The 176713 and 176714 Modification Kits, when installed on Teletype Model 28 Cabinets (LAAC or LAC respectively), provide a low-paper and paper-out alarm device. The audible or visual alarm must be provided by the customer.

b. The 176713 Modification Kit consists of:

2	2191	Washer, Lock	1	176667	Spacer
2	7002	Washer, Flat	1	176668	Bracket W/Stud
2	79523	Screw	1	176669	Lever W/Hub and Pin
2	98642	Washer, Lock	1	176670	Lever W/Hub
2	112627	Nut	2	176671	Insulator
2	113844	Screw	1	176707	Bracket, Switch
2	119649	Ring, Retainer	1	176711	Spring, Torsion (Right Hand)
2	124999	Switch	1	176712	Spring, Torsion (Left Hand)
2	151229	Washer, Flat	1	176785	Cable Assembly
2	151657	Screw			

c. The 176714 Modification Kit consists of:

2	2191	Washer, Lock	1	176668	Bracket W/Stud
2	7002	Washer, Flat	1	176669	Lever W/Hub and Pin
2	79523	Screw	1	176670	Lever W/Hub
2	112627	Nut	2	176671	Insulator
2	119649	Ring, Retainer	1	176708	Bracket
2	151229	Washer, Flat	1	176711	Spring, Torsion (Right Hand)
2	151657	Screw	1	176712	Spring, Torsion (Left Hand)
1	176667	Spacer	1	176786	Cable Assembly

d. For parts referred to other than those listed above, and for parts ordering information refer to the appropriate Teletype Parts Bulletin (Bulletin 1149B (KSR) for 176714 Modification Kit; Bulletin 1169B (ASR) for 176713 Modification Kit).

2. INSTALLATION (Figures 1 and 2)

a. 176713 Modification Kit

(1) Assemble the components of the 176713 Modification Kit in accordance with

Figure 1.

(2) Attach the yellow lead of the 176785 Cable Assembly to the middle connector of the Paper-Out switch (on the left side of the assembly as viewed in Figure 1). Attach the purple lead to the bottom connector of the same switch.

(3) Attach the White-Orange lead of the 176785 Cable Assembly to the middle connector of the Low-Paper switch (on the right side of the assembly as viewed in Figure 1). Attach the White-Green lead to the bottom connector of the same switch.

(4) Secure the 176713 Modification Kit to the cabinet in the following manner:

(a) Remove and discard the 151723 Screw, 151572 Lock Washer, and 117535 Flat Washer from the "fourth" and "fifth" (from the right hand side as viewed from the front of unit) holes in the hinge that secures the 154410 Cabinet Dome to the lower portion of the cabinet.

(b) Place the 176707 Bracket over the two holes made available in step (a) above, and secure the bracket using two 113844 Screws, two 98642 Lock Washers and two 151229 Flat Washers.

b. 176714 Modification Kit

(1) Assemble the components of the 176714 Modification Kit in accordance with Figure 2.

(2) Secure the 176708 Bracket of the alarm assembly to the "center" and "right-hand" studs that secure the left dome hinge to the lower section of the cabinet as follows:

(a) Remove the 125231 Nut, 98642 Lock Washer and 35826 Flat Washer from the above specified studs.

(b) Place the 176708 Bracket over the two studs and secure the bracket using the two 151229 Washers and the washers, lock washers, and nuts removed in Paragraph (a) above.

3. ADJUSTMENTS AND LUBRICATION (PERTAINS TO BOTH KITS)

a. Switch Bracket - With forms feeding into the page printer, the low-paper switch should operate upon sensing the notch provided near the end of the forms, and the paper-out switch should operate at the end of the forms. To adjust, loosen the switch bracket mounting screws and position the bracket. Tighten the screws.

b. Low-Paper and Paper-Out Lever Spring Tensions - It should require 1/4 to 1-1/2 ounces to pull the low-paper and paper-out levers up to a point where the switches just operate. To measure, hook the pull end of an 8 ounce spring scale under the end of each lever and pull vertically upward.

c. Apply one or two drops of KS7470 oil at the pivot of each of the two levers.

4. WIRING

a. 176713 Modification Kit - Connect the leads of the 176785 Cable Assembly to the "C" terminal boards of the LAAC Cabinet as follows:

<u>LEAD</u>	<u>TERMINAL</u>
Yellow	C-25
Purple	C-26
White-Orange	C-220
White-Green	C-219

b. 176714 Modification Kit - Connect the leads of the 176786 Cable Assembly to the "C" terminal boards of the LAC Cabinet as follows:

<u>LEAD</u>	<u>TERMINAL</u>
Yellow	C-25
Purple	C-26
White-Orange	C-80
White-Green	C-58

\*

\*

\*

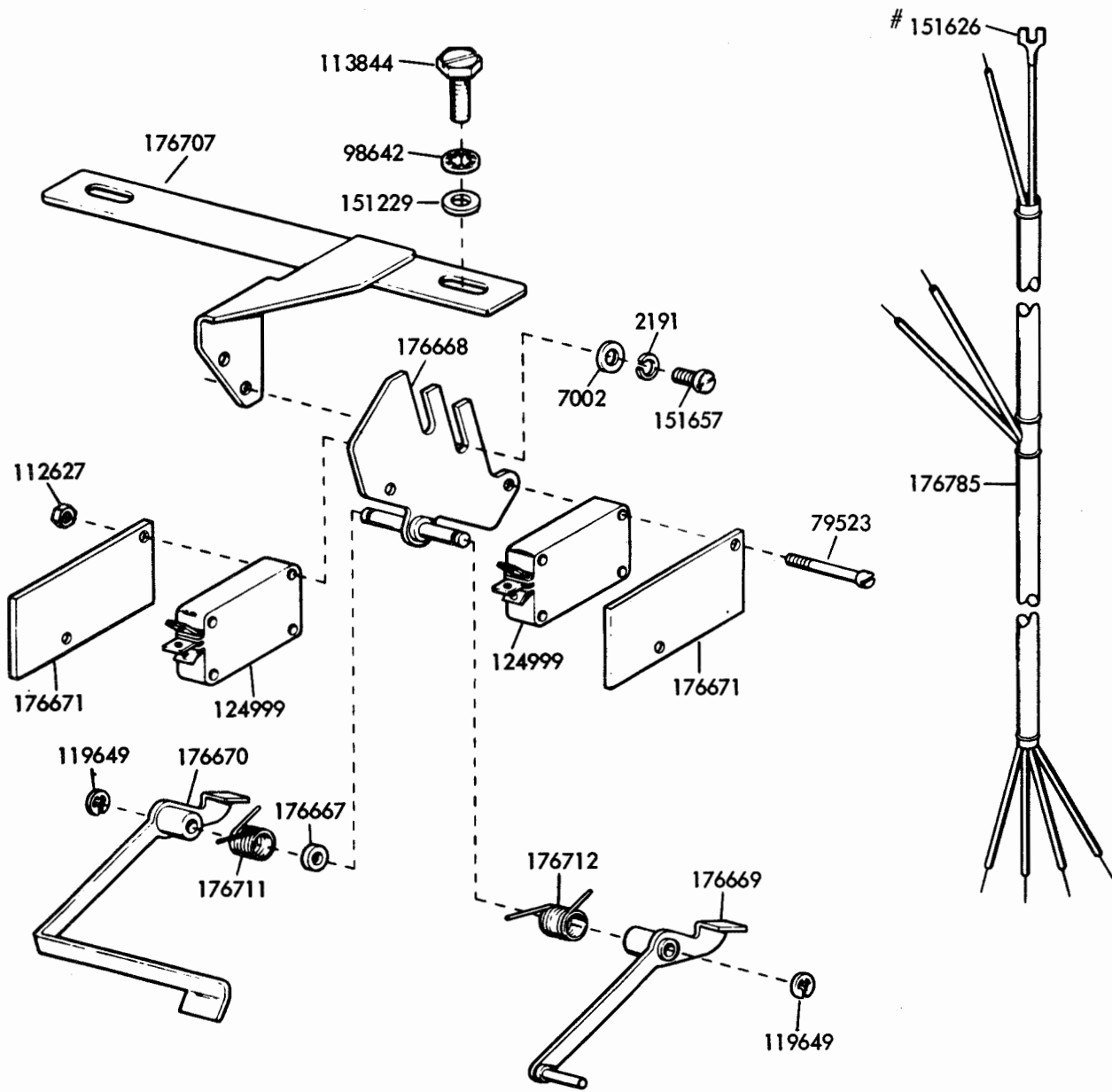

# PART OF 176785

Figure 1. 176713 Modification Kit to Provide Low-Paper and Paper-Out Alarm



